

M310

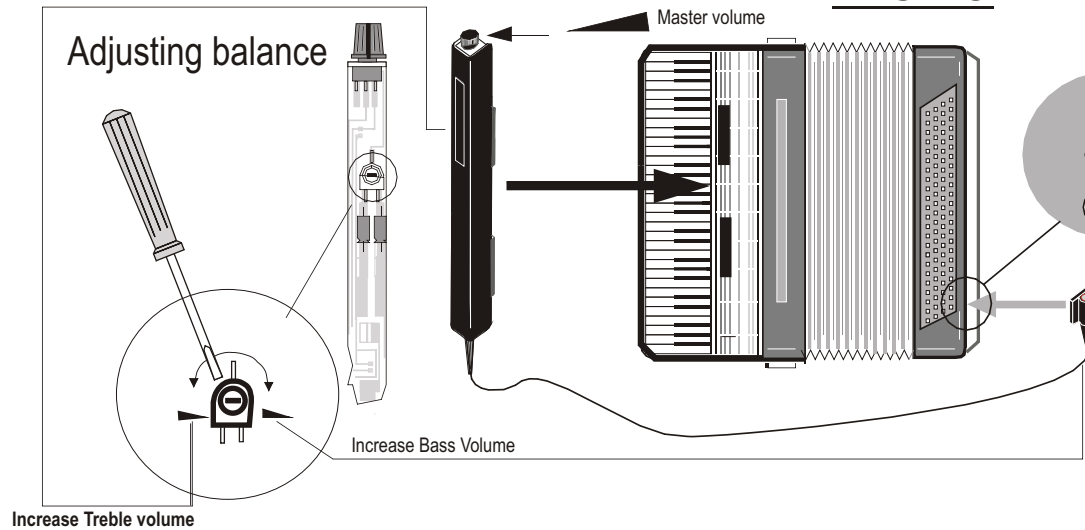

M405/M410/M420

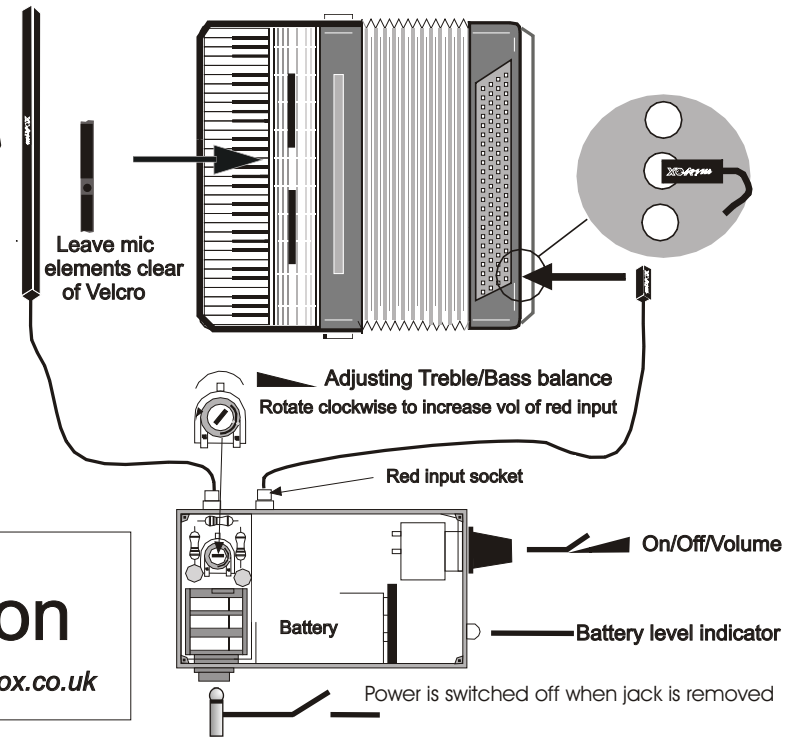

microX The Sound Solution

24 Huddersfield Rd, Thongsbridge, Holmfirth, W. Yorks HD9 3JL, UK. +44 (0)1484 684049 www.microvox.co.uk

Thank you for purchasing a Microvox Microphone

The microphone will work using the line (jack) input on your amplifier/mixer but the volume level may be low. If this is the case then connect to the 'Mic' input for maximum volume. This is often a three pin XLR socket. You will need a 1/4" jack to XLR cable or an adaptor. The standard pin configuration is:
Signal - Pin 2
Screen - Pins 1&3
We can provide a jack/XLR cable if necessary.

If you are connecting via an XLR input, the phantom power must be switched off on that channel. If this is impossible because your mixer has global phantom power and it is needed for another device, a DI box should be used to isolate the phantom power.

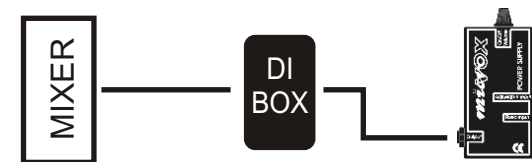

With the M405/M410/M420 systems the PSU has two inputs. Both inputs are factory set at maximum gain. The adjustable input can be turned down in order to balance the mics. See above diagram. Usually, the bass mic is too loud so connect that one to the adjustable input where it can be turned down. The microphone will work with most guitar wireless systems. Plug the guitar transmitter cable into the output socket.

Replace the battery at least annually with a good quality product.

Guarantee

This product is guaranteed for three years from the date of purchase. Any faults which are not caused by misuse will be repaired free of charge within that period.